

5. Instructions to Extend the Life of Product

Daily care

[Cloth part]

- Brush with a soft brush or tap the surface softly and vacuum to remove dust to avoid damaging the cloth.
- When it gets dirty after extended period of time, wipe with a well wrung soft cloth moistened with thin neutral detergent. Wipe clean with a damp cloth. Be sure to wipe detergent completely and wipe again with a dry cloth to dry it.
- When using alkaline electrolyzed water to remove stains, spray directly on the stain and brush with a soft brush taking care not to damage the cloth. Then, wipe the moisture and stain to remove and wait for the cloth to dry.
- When it gets an oily stain, dab and remove it by using a dedicated stain remover immediately. Then wipe with a soft cloth dampened with water, followed by a dry cloth to dry. Stains may be permanent depending on the material.

— Please be careful. —

- Remove stains as quickly as possible.
- Avoid causing a circular stain, remove not only the stain but also wipe off thoroughly around the stain.
- Try the cleaner on inconspicuous area first since the surface may discolor or deteriorate by using it.

[Aluminum part]

- Wipe with a clean, dry, soft cloth.
- Immediately wipe off any water or fingerprints (sebum). Please note that the aluminum portion will get oxidized to lose its gloss and deteriorate the texture if the chair is left with water or fingerprints (sebum) attached.

[Leather part]

- Wipe with a clean, dry, soft cloth.
- Immediately wipe off any liquid with a dry cloth. If dirt cannot be removed, wipe using a cloth moistened with slightly warm water.

— Please be careful. —

- Do not use an organic solvent such as thinner and benzene, alcohol, a chemical cloth or a shoe cleaner. Please note that the chair with its color or texture deteriorated cannot be restored to its original state.

[Wooden Part]

- Gently wipe with a clean, dry, and soft cloth in the direction of the grain.
- When it gets exceptionally dirty, wipe off the dirt with a well wrung soft cloth moistened, and wipe again with a dry cloth to dry it.

— Please be careful. —

- Do not use the following items which will damage the coating.
 - ◎ Thinner, benzene, alcohol, lacquer, oil, vinegar, boiling water, polishing powder, etc.
- Do not frequently wipe with a cloth moistened, otherwise, the wood portion will be cracked.

[Resin Part]

- Wipe with a well wrung soft cloth moistened.
- If dirt is noticeable, wipe it off with a well wrung soft cloth moistened with thin neutral detergent. Be sure to remove detergent completely with a damp cloth and wipe again with a dry cloth to dry it.

Lounge Chair

Phlox Chair

Instructions for Use



OKAMURA

OKAMURA CORPORATION

International Sales & Marketing Div.
www.okamura.com

G150J4/2022-05

OKAMURA

1. Safety Instructions (Be sure to follow these instructions)

Information on Graphic Symbols

This Instruction Manual and indications on the products use various types of symbols to help you safely and correctly use the products, preventing you, people nearby, and properties from being damaged. The symbols mean as shown below. Make sure to understand the meaning of the symbols well before reading the instructions.

 CAUTION	This indicates that improper handling may cause injury or property damage.
--	---

 The symbols are there to call your attention to the parts indicated.

CAUTION

Do not use this product as a step stool or as a transportation equipment.

- Do not use this product as a step stool or as a transportation equipment.
- Do not stand on the product or sit on the front edge portion of the seat.
- Do not sit on other than the seat.

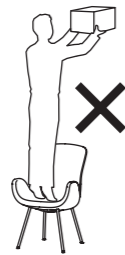

Be careful of the following items since it may cause injury or damage the product.

- Do not leave any abnormalities as is during use. Failure may cause the main unit to be broken and cause injury.
- If the product starts to creak due to loose bolts or screws, please be sure to tighten them again. Loosening may cause problems.
- Do not use the product if any parts have come off. It may cause damage or lead to accidents, such as tipping over.
- If you notice any irregularities, please contact our sales office.

Do not put your hands or fingers in the gaps or movable portions. Careless handling may cause injury.

Do not disassemble or repair the product.

- The part indicated by the arrow mark is filled with high-pressure gas. If you notice any irregularities, please contact our sales office without attempting to disassemble or repair the product on your own, since this may be very dangerous.

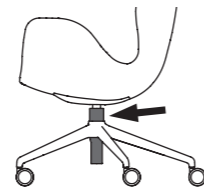

- Do not use the product with loose bolts or screws. Failure may cause the main unit to be broken and cause injury.

Never remodel the product. Failure may cause a malfunction or accident.

- Remodeling by the customer may cause a malfunction. In that case, Okamura will not take any responsibility or liability for any phenomena caused.
- If you need to remodel the product, contact our Customer Service.

2. Precautions for Use

Please follow the instructions below. Failure may cause damage to the product. In that case, Okamura will not take any responsibility or liability for any phenomena caused.

Installation

Be sure to use the product indoors.

- Do not use the product outdoors or in places exposed to water. Failure may cause damage such as warping and mold.

Avoid places directly exposed to heat or wind from stoves or air conditioners. Failure may cause deformation or discoloration.

Avoid places with high temperature, high humidity, and extreme dryness. Failure may cause deformation, discoloration, and mold.

Avoid places exposed to direct sunlight. Failure may cause deformation or discoloration.

- When installing the product near windows, constantly block direct sunlight with curtains, blinds, etc.

Install the product so that it will be horizontal.

- When installing the product, be sure to keep the body horizontal. Failure may cause the body to be distorted or the movable portion to be defective.

Characteristics of natural wood

Natural wood varies in graining and color due to a natural material. The surface of the material is treated for durability improvement and protection as furniture, providing soft and calm texture of the natural material. The surface treatment may cause slight differences in color due to originality of the material, which is also a characteristic of the natural material. Further, the color will be deepened to generate grace and dignity over time. Some products may generate wood-specific smell or may get moldy if left in humid places. It is recommended to practice regular ventilation. Please understand those characteristics and carefully read this manual for your long and continued use.

Characteristics of leather upholstery

- Since leather is a natural material, there may be slight differences in texture including creases, unevenness, and gullies depending on the portion. In addition, scratches may be viewed on the surface; scars of injury that the animal concerned got in the natural world. Those prove that the animal was alive and are great differences from artificially made synthetic leather. Therefore, they will never ruin the functions or quality of the material.

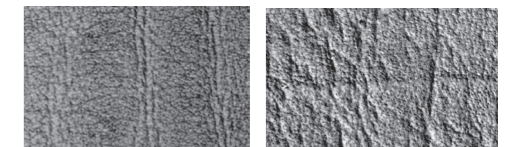

Wrinkle/gully (creases from the neck to the chest made to move the neck) Scratch (scar)

- The surface of this leather is treated with a high technology to be water-resistant and stain-resistant without ruining the leather-specific features. The soft and supple touch of the leather will fit you over time.
- Clothes or leather may rub against the leather of the chair to generate sound depending on the leather covering method and design. This is specific to leather.

Appropriate Ventilation Measures

- Many chemical substances will be released by the product when it is first purchased. Sufficiently ventilate or expose the product to moving air for some time after purchasing it.
- Do not completely close windows when using the product in rooms with conspicuously high temperatures/ humidity (the benchmarks for these are temperatures in excess of 28°C (82.4°F) and relative humidity in excess of 50%).

3. How to use the product

Parts Name

[Lounge Chair]

Aluminum 4-star leg

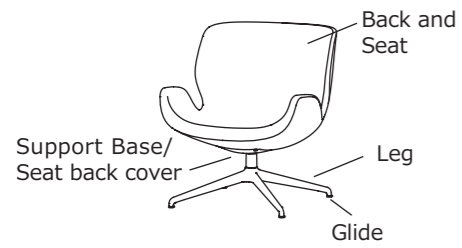

Pipe leg

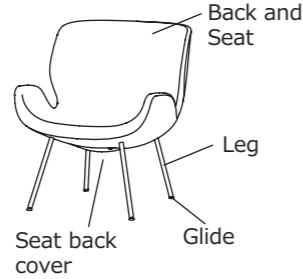

Wooden leg

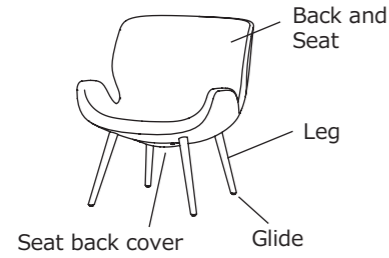

[High stool]

Pipe leg

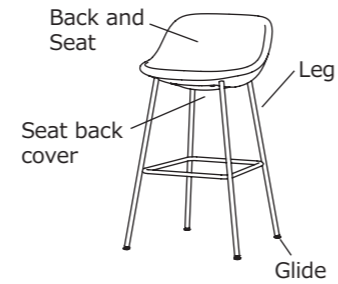

Wooden leg

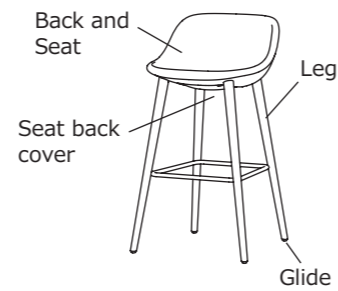

[Conference Chair]

Aluminum 5-star leg (Caster)

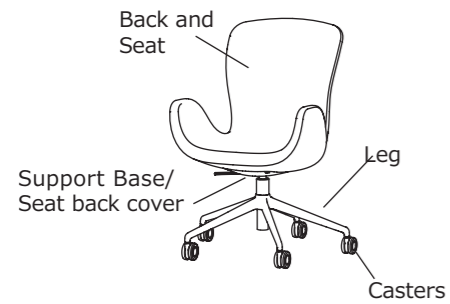

Aluminum 4-star leg (Caster)

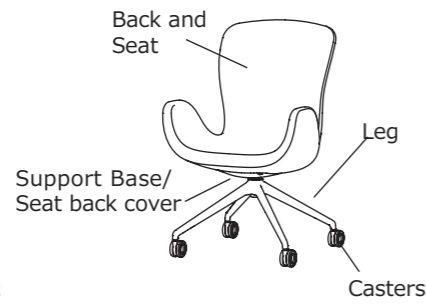

Aluminum 4-star leg

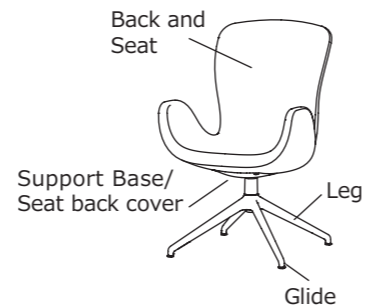

Pipe leg

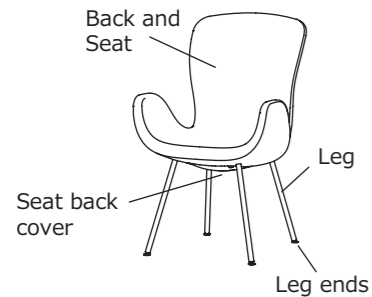

Wooden leg

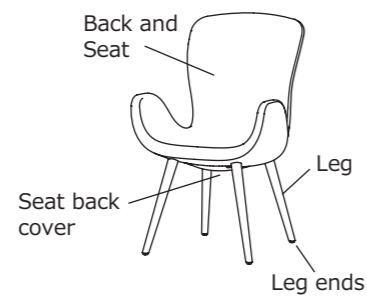

3. How to use the product

[Chair Tilt Lock]

If you lean against the back of an aluminum-legged conference chair or an aluminum-legged lounge chair, the chair will fall over backwards. The angle of the back rest is locked to a range of -4° (forward) to 7° (backward).

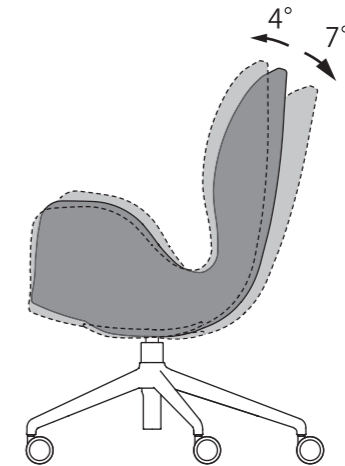

[Seat Rotation]

The aluminum-legged conference chairs and the aluminum-legged lounge chairs feature rotating seats. (There is no auto-return function.)

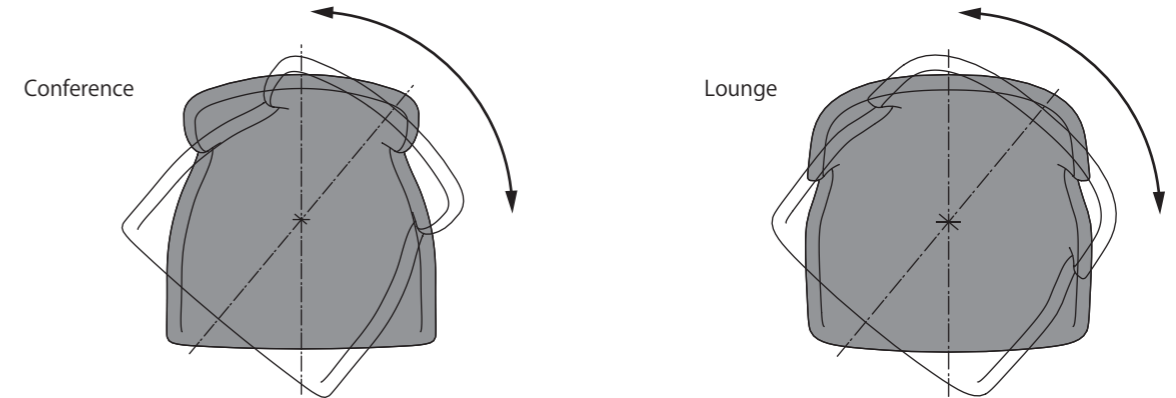

[Seat Height Adjustment]

Adjust seat height using the up/down seat adjustment lever located on the lower right side of the seat. Pull the lever upwards with your weight on the chair to lower the seat, and release the lever to fix the height at the desired level. To raise the seat, lift yourself up slightly while raising the lever.

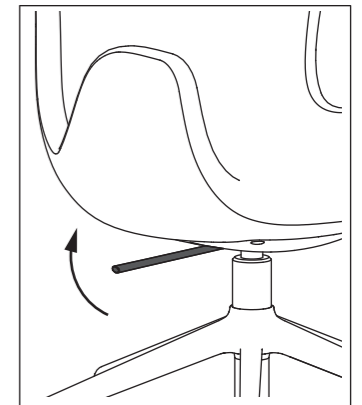
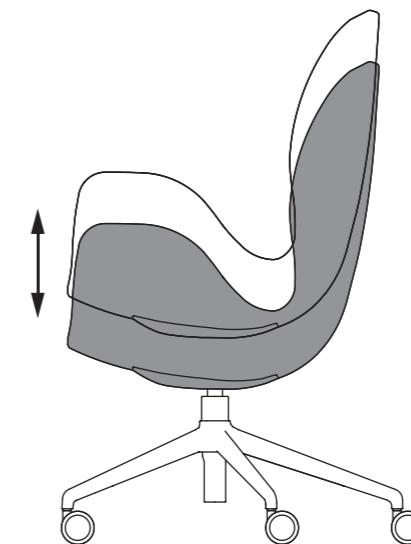

3. How to use the product

Troubleshooting

Problem	Check	Solution	Page
The seat cannot be lifted up.	Are you sitting on the seat when adjusting the seat height?	Adjust the seat height while not seated on the seat.	4
	Is the seat height in its highest position?	The seat cannot be lifted up beyond the highest position.	4
The seat cannot be lowered.	Are you sitting on the front edge of the seat?	Sit in the center of the seat while adjusting.	4
	Is the seat height in the lowest position?	The seat cannot be lowered beyond the lowest position.	4
Casters do not move smoothly.	Are they tangled with lint or wool?	Remove lint or wool or replace the casters.	*
Casters are slippery.	Are you using urethane casters on hard floors such as a plastic tile floor?	Use soft casters.	

*Please contact an official dealer.

4. Specifications

Materials and Surface Finish

Parts		Materials	Surface Finish	
Structural parts	Inner shell	Polypropylene	—	
	Aluminum leg	Support base	Metal (aluminum), Metal (Steel)	Polyester coating
		Leg	Metal (aluminum)	Polyester coating
	Pipe leg	Leg	Metal (Steel)	Polyester coating
	Wooden leg	Support base	Metal (Steel)	Polyester coating
		Leg	Natural wood	Urethane resin coating
	Hollow caster	Polyurethane	—	
	Normal caster	Nylon	—	
	Glide(Pipe leg)	Nylon, ABS resin	—	
Glide(Wooden leg)	Polyethylene	—		
Cushion material		Urethane foam	—	
Seat back cover		Polypropylene	—	
Covering material	Cloth	76% recycled PET, 24% REAMIDE (6% nylon recycled from fishing nets)	—	
	Leather Upholstery	Leather (bull leather)	—	

5. Instructions to Extend the Life of Product

Operating Precautions and Maintenance

- If the product has become unsteady due to loosening of the bolts or screws during use, retighten them immediately.
- Avoid direct exposure to steam. Failure will cause rust.
- This Instruction Manual is very important, so store it in an easily accessible location.
- Regular maintenance is recommended for long-life use. Please request us early for inspections and repairs (fees required) when the warranty has expired.
- Hard caster(Nylon wheels) may slide too well to cause the chair to fall. Use Soft caster (urethane wheels). The nylon wheels are suited for floors covered with rugs or carpets.

- Casters
Casters should be replaced when they are worn down. Any irregularities that are noticeable when moving, such as heaviness, noise from the casters, or rattling from the chair, are due to caster wear and tear. We recommend replacing the casters.

- Parts replacement
For parts replacement and after-sales service, contact our dealer.

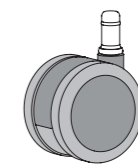

Normal caster (Nylon caster)

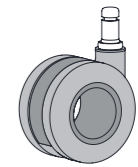

Hollow caster (Urethane caster)

Please be careful.

- The soft wheels change over time due to the effects of hydrolysis, mold growth, ultraviolet rays, etc., causing deterioration such as crack and peeling. The speed of soft wheel aging greatly varies depending on your environment. If you find any deterioration, you are recommended to replace the wheels concerned as early as possible.